

Thermal Performance Merges with Adaptable Design to Offer More Choices



Maine East High School
Park Ridge, Illinois
ARCHITECT
ARCON Associates Inc., Lombard, Illinois
PHOTOGRAPHY
© Bill Gnech / The Apple Group

Building codes and energy requirements continue to evolve at a rapid rate, requiring high-performing products for a variety of applications. NX-3000 Series Thermal Windows offer a high-performing, comprehensive solution designed to address the aesthetic and energy demands of the market. With outstanding air, water and structural performance, NX-3000 Series Thermal Windows are ideal for school applications where condensation and mold are significant concerns and safety and durability are essential.

A range of installation options, glazing features and hardware durability are a few elements that allow these adaptable windows to go to the front of the class. Proven performance and superior strength make this window series a wonderful choice for new or retrofit construction. With NX-3000 Series Thermal Windows, choice is everything.

PERFORMANCE

By incorporating an innovative barrier system, NX-3000 Series Thermal Windows deliver enhanced thermal performance. The high-performance energy spacer provides reduced U-factors when compared to a conventional insulated glazing unit with a metal spacer. The combination furnishes an insulation barrier that results in excellent energy efficiency.

Thermal efficiency and operable ventilators make the window ideal for buildings seeking to earn LEED® (Leadership in Energy and Environmental Design) certification with the U.S. Green Building Council.

The NX-3000 Series meets the minimum requirements for the Architectural Window (AW) performance class and has been life-cycle tested to the AAMA standard. Made from aluminum, this high-performing window series offers unlimited finish options, installation flexibility and sustainable benefits such as recyclability. Furthermore, the window will not rot, warp or buckle due to moisture and weather exposure.

FABRICATION AND INSTALLATION

NX-3000 Series Windows can be used on new or retrofit applications. A number of installation options and accessories are available. Additionally, the windows are versatile to address custom field applications.

NX-3100
3-1/4" ARCHITECTURAL OVERLAP
CASEMENT OUTSWING
THERMAL ALUMINUM WINDOW

High-Performance
Thermal
Barrier System

1" Insulating Glass

High-Performance
Energy Spacer

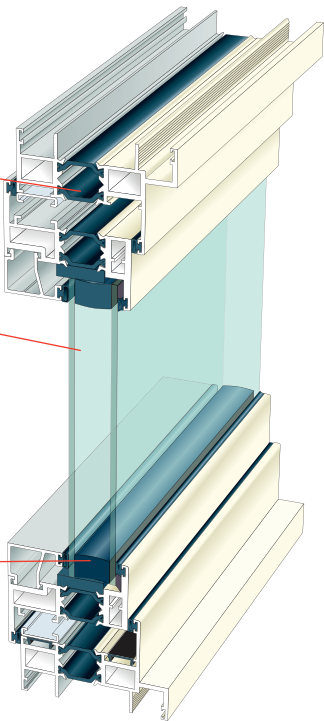

AESTHETICS AND VERSATILITY

This innovative 3-1/4" architectural window is available in several configurations, including fixed, casement, and projecting. Concealed stainless steel hinges offer a more streamlined appearance on most NX-3000 models. Options for internal blinds and insect screens are also available on several models.

MODEL	AW RATING	FUNCTION
NX-3100	80	Overlap Casement Outswing
NX-3200	80	Overlap Casement Inswing
NX-3400	80	Overlap Project-In
NX-3500	80	Overlap Project-Out
NX-3800	80	Fixed

A dual color option provides the flexibility to vary interior and exterior finishes.



Maine East High School
Park Ridge, Illinois
ARCHITECT
ARCON Associates, Inc., Lombard, Illinois
PHOTOGRAPHY
Courtesy of Main Township School District